

VAUXMONT METROPOLITAN DISTRICT

PARCELS OF LAND LOCATED IN THE NORTH HALF OF SECTION 21, SECTION 22, AND NORTH HALF OF SECTIONS 23 AND 24, ALL IN TOWNSHIP 2 SOUTH, RANGE 70 WEST OF THE SIXTH PRINCIPAL MERIDIAN, CITY OF ARVADA, COUNTY OF JEFFERSON, STATE OF COLORADO, BEING MORE PARTICULARLY DESCRIBED AS FOLLOWS:

THE FOLLOWING LOTS, BLOCKS, AND TRACTS OF CANDELAS FILING NO. 1 PLAT AS RECORDED AT RECEPTION NUMBER 2011039877:

- TRACT A1, BLOCK 1; TRACT A2, BLOCK 1; TRACT B, BLOCK 1; TRACT W, BLOCK 1; TRACT FFF, BLOCK 1;
- BLOCK 8;
- BLOCK 9;
- BLOCK 10;
- BLOCK 11;
- LOTS 1-13, BLOCK 12; TRACT DD, BLOCK 12;
- LOTS 1-9, BLOCK 13; TRACT GG, BLOCK 13;
- LOTS 1-12, BLOCK 14; TRACT CC, BLOCK 14;
- LOTS 1-12, BLOCK 15; TRACT FF, BLOCK 15;
- LOTS 1-12, BLOCK 16; TRACT HH, BLOCK 16;
- LOTS 1-16, BLOCK 17; TRACT II, BLOCK 17;
- LOTS 1-35, BLOCK 18; TRACT A3, BLOCK 18; TRACT A4, BLOCK 18;
- LOTS 1-16 BLOCK 19 TRACT JJ, BLOCK 19;
- LOTS 1-13 BLOCK 20 TRACT MM, BLOCK 20;
- BLOCK 21;
- BLOCK 22;
- LOTS 1-8, BLOCK 23; TRACT NN, BLOCK 23;
- LOTS 1-22, BLOCK 24; TRACT A5, BLOCK 24;
- LOTS 1-46, BLOCK 25; TRACT OO1, BLOCK 25;
- LOTS 1-11, BLOCK 26; TRACT PP, BLOCK 26;
- LOTS 1-50, BLOCK 27; TRACT QQ, BLOCK 27; TRACT RR, BLOCK 27; TRACT AAA, BLOCK 27;
- LOTS 1-11, BLOCK 28; TRACT A6, BLOCK 28; TRACT BBB, BLOCK 28;
- LOTS 1-6, BLOCK 29; TRACT A7, BLOCK 29;
- LOTS 1-19, BLOCK 30; TRACT OO2, BLOCK 30;
- TRACT UU, BLOCK 31; TRACT V V, BLOCK 31;
- LOTS 1-15, BLOCK 32; TRACT A8, BLOCK 32; TRACT SS, BLOCK 32; TRACT CCC, BLOCK 32;
- LOTS 1-21, BLOCK 33; TRACT TT, BLOCK 33;
- LOTS 1-3, BLOCK 36; TRACT A9, BLOCK 36;
- TRACT KK, BLOCK 37; TRACT LL, BLOCK 37; TRACT ZZ, BLOCK 37;
- BLOCK 38;
- TRACT EE, BLOCK 39; TRACT YY, BLOCK 39;

SAID BLOCKS, LOTS, AND TRACTS CONTAIN 176.818 ACRES (7,702,191 SQ. FT.), MORE OR LESS.

TOGETHER WITH:

THE FOLLOWING LOTS, BLOCKS, AND TRACTS OF CANDELAS FILING NO. 1 AMENDMENT NO. 1 PLAT AS RECORDED AT RECEPTION NUMBER 2012013131:

- LOTS 1-22, BLOCK 1-B; TRACT HHH, BLOCK 1-B; TRACT III, BLOCK 1-B;
- LOTS 1-11, BLOCK 2-B; TRACT GGG, BLOCK 2-B;
- LOTS 1-17, BLOCK 3-B; TRACT KKK, BLOCK 3-B;
- LOTS 1-14, BLOCK 4-B; TRACT JJJ, BLOCK 4-B;
- LOTS 1-22, BLOCK 5-B; TRACT LLL, BLOCK 5-B; TRACT OOO, BLOCK 5-B;
- LOTS 1-22, BLOCK 6-B; TRACT MMM, BLOCK 6-B; TRACT PPP, BLOCK 6-B;
- LOTS 1-19, BLOCK 7-B; TRACT NNN, BLOCK 7-B; TRACT QQQ, BLOCK 7-B; TRACT RRR, BLOCK 7-B; TRACT SSS, BLOCK 7-B;
- TRACT UUU, BLOCK 29-B;

SAID BLOCKS, LOTS, AND TRACTS CONTAIN 24.932 ACRES (1,086,060 SQ. FT.), MORE OR LESS.

TOGETHER WITH:

THE FOLLOWING LOTS, BLOCKS, AND TRACTS OF CANDELAS FILING NO. 2 PLAT AS RECORDED AT RECEPTION NUMBER 2013043564:

- LOTS 1-14, BLOCK 1; TRACT A, BLOCK 1; TRACT E, BLOCK 1; TRACT F, BLOCK 1; TRACT G, BLOCK 1;
- LOTS 1-8, BLOCK 2;
- LOTS 1-27, BLOCK 3;
- LOTS 1-37, BLOCK 4;
- LOTS 1-29, BLOCK 5;
- LOTS 1-34, BLOCK 6; TRACT B, BLOCK 6;
- LOTS 1-43, BLOCK 7; TRACT C, BLOCK 7; TRACT D, BLOCK 7; TRACT H, BLOCK 7;
- LOTS 1-7, BLOCK 8;
- BLOCK 11;
- BLOCK 12;
- BLOCK 13;
- BLOCK 14;

SAID BLOCKS, LOTS, AND TRACTS CONTAIN 115.142 ACRES (5,015,604 SQ. FT.), MORE OR LESS.

TOGETHER WITH:

THE FOLLOWING LOTS, BLOCKS, AND TRACTS OF CANDELAS FILING NO. 3 PLAT AS RECORDED AT RECEPTION NUMBER 2013117890:

- LOT 1, BLOCK 1;
- LOT 1, BLOCK 2;
- LOTS 1-21, BLOCK 3; TRACT C, BLOCK 3; TRACT L, BLOCK 3;
- LOTS 1-25, BLOCK 4;
- LOTS 1-9, BLOCK 5;
- LOTS 1-14, BLOCK 6; TRACT D, BLOCK 6; TRACT E, BLOCK 6; TRACT F, BLOCK 6;

- LOTS 1-6, BLOCK 7; TRACT B, BLOCK 7;
- LOTS 1-7, BLOCK 8; TRACT A, BLOCK 8;
- LOT 1, BLOCK 9;
- LOT 1, BLOCK 10;
- LOTS 1-27, BLOCK 11; TRACT J, BLOCK 11; TRACT K, BLOCK 11;
- LOTS 1-23, BLOCK 12; TRACT I, BLOCK 12; TRACT N, BLOCK 12;
- LOTS 1-19, BLOCK 13;
- LOTS 1-12, BLOCK 14;
- LOTS 1-19, BLOCK 15; TRACT G, BLOCK 15; TRACT M, BLOCK 15;
- LOTS 1-30, BLOCK 16;
- LOTS 1-19, BLOCK 17;
- LOTS 1-31, BLOCK 18; TRACT H, BLOCK 18;

SAID BLOCKS, LOTS, AND TRACTS CONTAIN 332.885 ACRES (14,500,453 SQ. FT.), MORE OR LESS.

BASIS OF BEARING

BASIS OF BEARING ARE BASED ON THE PLATTED BEARING OF N89°40'01"E ALONG THE NORTH LINE OF THE NORTHEAST QUARTER OF SECTION 24, AS SHOWN ON CANDELAS FILING NO. 1 AS RECORDED AT RECEPTION NO. 2011039877, AND AS DETERMINED BY MONUMENTS BEING A FOUND 3-1/4" ALUMINUM CAP STAMPED LS 16837 AT THE NORTHEAST CORNER AND BEING A FOUND STONE AT THE NORTH QUARTER CORNER OF SECTION 24.

PREPARED BY DAVID A KUNTZ, PE
FOR AND ON BEHALF OF
MARTIN/MARTIN INC.
12499 W. COLFAX AVE.
LAKEWOOD, CO. 80215
(303) 431-6100
(303) 431-4028 FAX
JANUARY 06, 2014

VAUXMONT METROPOLITAN DISTRICT
DISTRICT BOUNDARY MAP

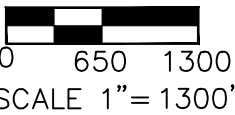
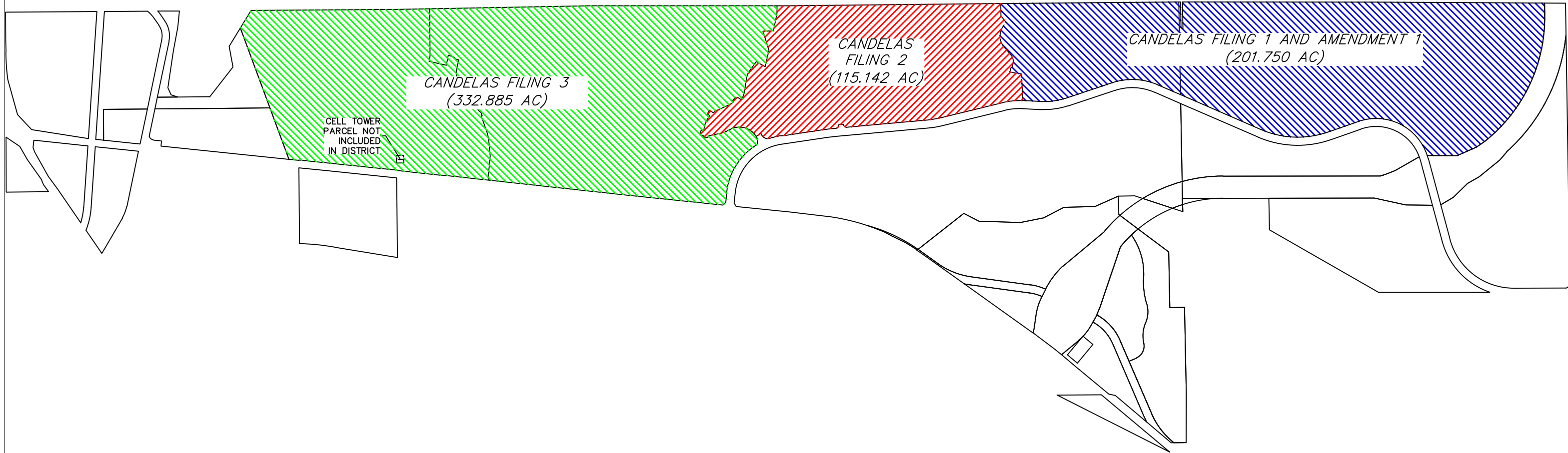

JANUARY 06, 2014



NOTES:

ALL AREAS REPORTED EXCLUDE RIGHT-OF-WAY DEDICATED WITH THE PLAT.

FOR DETAILED INFORMATION SEE THE FOLLOWING DOCUMENTS:

- CANDELAS FILING NO. 1 FINAL PLAT RECORDED AT REC. NO. 2011039877
- CANDELAS FILING NO. 1 AMENDMENT NO. 1 FINAL PLAT RECORDED AT REC. NO. 2012013131
- CANDELAS FILING NO. 2 FINAL PLAT RECORDED AT REC. NO. 2013043564
- CANDELAS FILING NO. 3 FINAL PLAT RECORDED AT REC. NO. 2013117890

LEGEND

-  CANDELAS FILING 1 AND AMENDMENT 1
-  CANDELAS FILING 2
-  CANDELAS FILING 3 (INCLUDES FUTURE FILING 4 AREA)



12499 WEST COLFAX AVE.
P.O. BOX 151500
LAKEWOOD, CO 80215
303.431.6100
FAX 303.431.4028